

Item Name  
商品名称

**DM50-5**

Built in Encoder and driver, I2C bus interface  
Ultra high torque, precision control



## DIMENSION

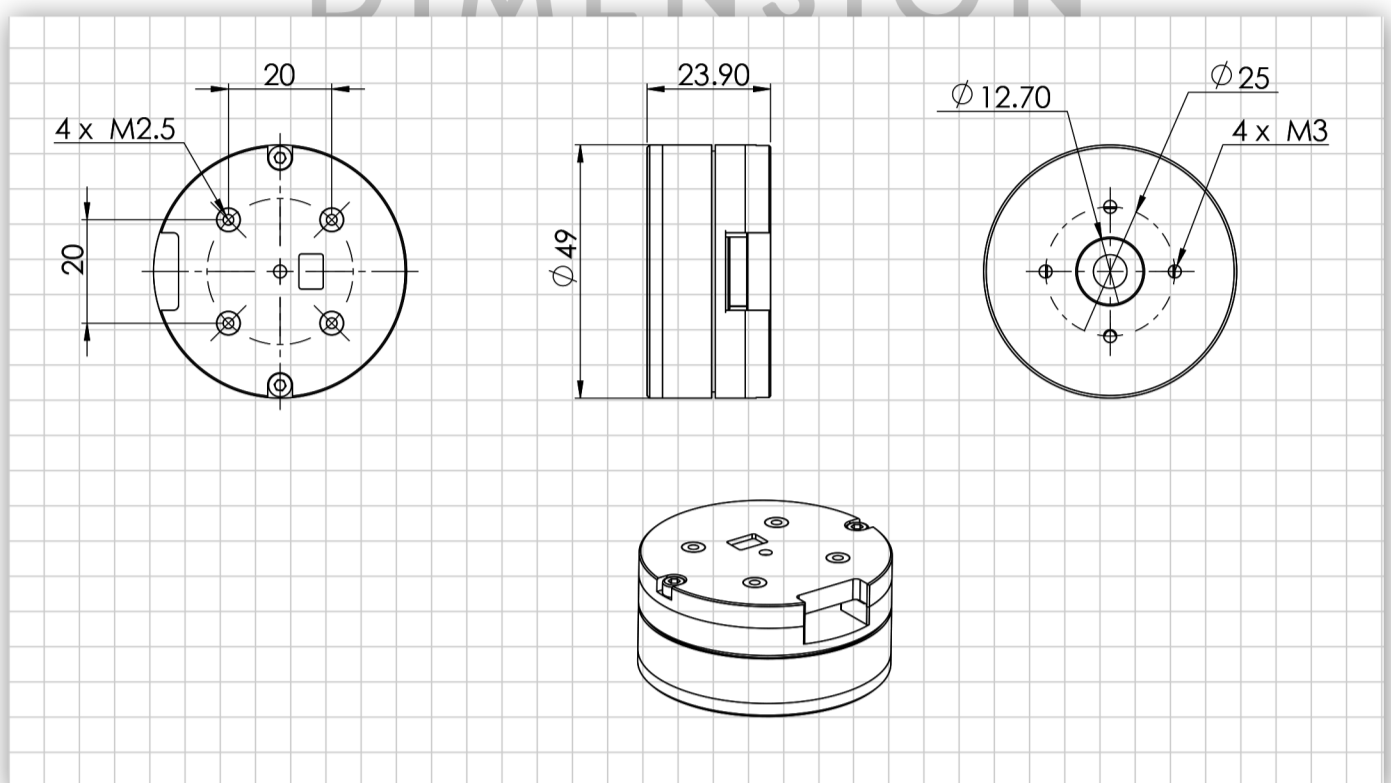

## SPECIFICATION

|                               |                 |
|-------------------------------|-----------------|
| 型号 (item name)                | DM50-05         |
| 重量 (weight;g)                 | 90              |
| 尺寸 (Dimension;mm)             | 49x23.5         |
| 结构 (configuration)            | 24N28P          |
| 电机输入电压 (input volatge)        | 10.5-16.8V      |
| 驱动器 (drive board)             | sinewave driver |
| 驱动器输入电压 (Drive board voltage) | 10.5-21.00V     |
| 驱动允许最大电流 (max current)        | 2.5A            |
| 中孔直径 (hollow diameter;mm)     | 12.6            |
| 电机安装孔 (motor fixed diameter)  | 20, 4xM2.5      |
| 最大负载 (max payload, kg)        | 1.2             |

Actual measurement by GYEMS technical team

## ACCESSORIES



## DIMENSION

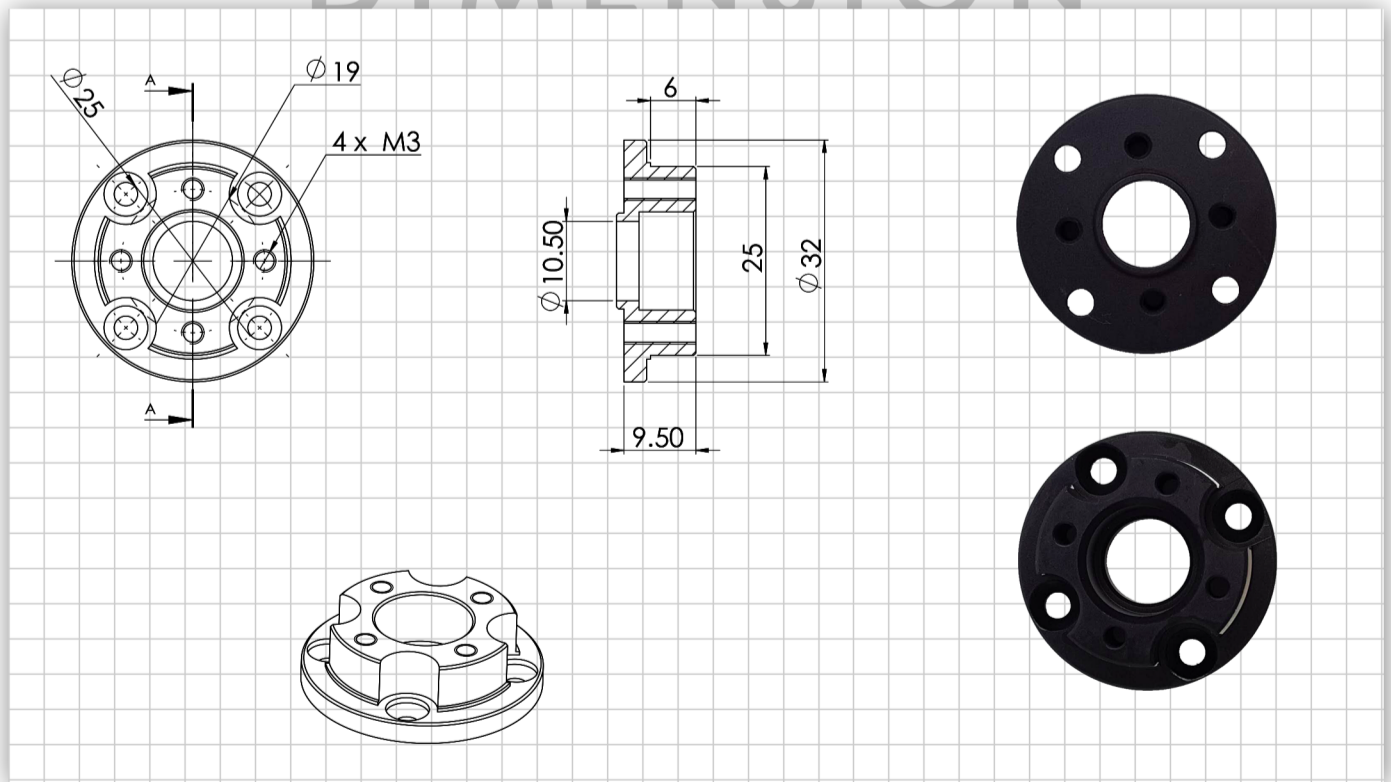

## DIFFERENT SIDES

